

WE-R(KEG)弯通接头-英制BSPT锥螺纹 DIN 3852-2 / Male BSPT taper thread DIN 3852-2

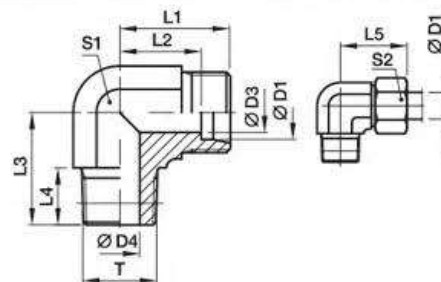

系列 Series	订货号* Order code*	D1 	T	D3	D4	L1	L2	L3	L4	L5	S1	S2	工作压力(bar)	
													CF	SS
LL	WE04LLR	04	R 1/8 tap.	3.0	4.0	15	11.0	17	8	21	9	10	100	100
	WE06LLR	06	R 1/8 tap.	4.5	4.5	15	9.5	17	8	21	9	12	100	100
	WE08LLR	08	R 1/8 tap.	6.0	6.0	17	11.5	20	8	23	12	14	100	100
	WE10LLR	10	R 1/4 tap.	8.0	7.0	18	12.5	23	12	24	12	17	100	
	WE12LLR	12	R 1/4 tap.	10.0	7.0	19	13.0	23	12	25	14	19	100	
L	WE06LR	06	R 1/8 tap.	4.0	4.0	19	12.0	20	8	27	12	14	315	315
	WE06LR1/4	06	R 1/4 tap.	4.0	6.0	21	14.0	26	12	29	12	14	315	315
	WE08LR	08	R 1/4 tap.	6.0	6.0	21	14.0	26	12	29	12	17	315	315
	WE08LR1/8	08	R 1/8 tap.	6.0	4.0	21	14.0	26	8	29	12	17	315	315
	WE08LR3/8	08	R 3/8 tap.	6.0	9.0	24	17.0	28	12	32	17	17	315	315
	WE10LR	10	R 1/4 tap.	8.0	7.0	22	15.0	27	12	30	14	19	315	315
	WE10LR3/8	10	R 3/8 tap.	8.0	9.0	24	17.0	28	12	32	17	19	315	315
	WE12LR	12	R 3/8 tap.	10.0	9.0	24	17.0	28	12	32	17	22	315	315
	WE12LR1/4	12	R 1/4 tap.	10.0	7.0	24	17.0	27	12	32	17	22	315	315
	WE12LR1/2	12	R 1/2 tap.	10.0	11.0	28	21.0	34	14	36	19	22	315	315
	WE15LR	15	R 1/2 tap.	12.0	11.0	28	21.0	34	14	36	19	27	315	315
	WE18LR	18	R 1/2 tap.	15.0	14.0	31	23.5	36	14	40	24	32	315	315
S	WE06SR	06	R 1/4 tap.	4.0	4.0	23	16.0	26	12	31	12	17	400	400
	WE06SR3/8	06	R 3/8 tap.	4.0	7.0	25	18.0	28	12	33	17	17	400	400
	WE08SR	08	R 1/4 tap.	5.0	5.0	24	17.0	27	12	32	14	19	400	400
	WE08SR3/8	08	R 3/8 tap.	5.0	7.0	25	18.0	28	12	33	17	19	400	400
	WE10SR	10	R 3/8 tap.	7.0	7.0	25	17.5	28	12	34	17	22	400	400
	WE10SR1/4	10	R 1/4 tap.	7.0	5.0	25	17.5	28	12	34	17	22	400	400
	WE10SR1/2	10	R 1/2 tap.	7.0	10.0	30	22.5	32	14	39	19	22	400	400
	WE12SR	12	R 3/8 tap.	8.0	8.0	29	21.5	28	12	38	17	24	400	400
	WE12SR1/2	12	R 1/2 tap.	8.0	11.0	30	22.5	32	14	39	19	24	400	400
	WE14SR	14	R 1/2 tap.	10.0	10.0	30	22.0	32	14	40	19	27	400	400
	WE16SR	16	R 1/2 tap.	12.0	12.0	33	24.5	32	14	43	24	30	400	400

*订货号不含螺母及卡套, 但包括其他的附件, 如密封圈
Without nut and ring, but including all other components such as seals