

Straight Union
Type FI-G • Series LL / L / S

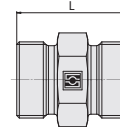
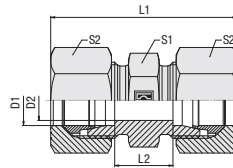

D

Ordering Codes

***FI-G*-10*L*-W3*-MS**

- * Straight Union FI-G
- * Outside Tube Diameter D1 (in mm) -10
- * Series LL
L
S
 - Extra-Light Series
 - Light Series
 - Heavy Series
- * Material Code -W3
 - Steel, zinc/nickel-plated
- Please contact STAUFF for alternative materials and surface finishings.
- * Assembling / Kitting —
 - Fitting body only
 - Fitting body supplied with cutting rings and union nuts -MS
 - Fitting body supplied with soft-sealing cutting rings and union nuts -MSV

Connecting Parts

- Cutting Ring
Type **FI-DS** Page 28
- Soft-Sealing Cutting Ring
Type **FI-WDDS** Page 29
- Support Sleeve
Type **FI-VH** Page 31
- STAUFF Form EVO Sealing Ring
Type **FI-FD** Page 32
- Union Nut
Type **FI-M** Page 33
- 37° Flared Tube Fitting Set
Type **FI-AB** Page 37

¹ Approximate dimension in assembled condition.
² Weight excluding cutting rings and union nuts.
³ Standard scope of delivery: Fitting body only.

Series	Tube OD		Dimensions						Weight (kg/lbs) ca. per 100	Ordering Codes ³	
	(mm/in)	PN (b2/fps)	D2	L	L1 ¹	L2	S1	S2			
LL	4	100	3	20	31	12	9	10	0,53	FI-G-04LL-W3	
	.16	1450	.12	.79	1.22	.47	.35	.39	1.16	FI-G-06LL-W3	
	6	100	4,5	20	32	9	11	12	0,79		
	.24	1450	.18	.79	1.26	.35	.43	.47	1.74	FI-G-08LL-W3	
	8	100	6	23	35	12	12	14	1,05		
	.31	1450	.24	.91	1.38	.47	.47	.55	2.30	FI-G-10LL-W3	
	10	100	8	23	35	12	14	17	1,29		
	.39	1450	.31	.91	1.38	.47	.55	.67	2.83	FI-G-12LL-W3	
	12	100	10	23	35	11	17	19	1,83		
	.47	1450	.39	.91	1.38	.43	.67	.75	4.03	L	
	6	500	4	24	39	10	12	14	1,44		FI-G-06L-W3
	.24	7250	.16	.94	1.54	.39	.47	.55	3.17		FI-G-08L-W3
8	500	6	25	40	11	14	17	1,90			
.31	7250	.24	.98	1.57	.43	.55	.67	4.18	FI-G-10L-W3		
10	500	8	27	42	13	17	19	2,60			
.39	7250	.31	1.06	1.65	.51	.67	.75	5.72	FI-G-12L-W3		
12	400	10	28	43	14	19	22	2,67			
.47	5800	.39	1.10	1.69	.55	.75	.87	5.87	FI-G-15L-W3		
15	400	12	30	46	16	24	27	4,81			
.59	5800	.47	1.18	1.81	.63	.94	1.06	10.57	FI-G-18L-W3		
18	400	15	31	48	16	27	32	6,65			
.71	5800	.59	1.22	1.89	.63	1.06	1.26	14.63	FI-G-22L-W3		
22	250	19	35	52	20	32	36	8,94			
.87	3625	.75	1.38	2.05	.79	1.26	1.42	19.66	FI-G-28L-W3		
28	250	24	36	54	21	41	41	13,90			
1.10	3625	.94	1.42	2.13	.83	1.61	1.61	30.57	FI-G-35L-W3		
35	250	30	41	63	20	46	50	21,11			
1.38	3625	1.18	1.61	2.48	.79	1.81	1.97	46.43	FI-G-42L-W3		
42	250	36	43	66	21	55	60	29,26			
1.65	3625	1.42	1.69	2.60	.83	2.17	2.36	64.38	S		
6	800	4	30	45	16	14	17	2,52		FI-G-06S-W3	
.24	11600	.16	1.18	1.77	.63	.55	.67	5.54		FI-G-08S-W3	
8	800	5	32	47	18	17	19	3,67			
.31	11600	.20	1.26	1.85	.71	.67	.75	8.08		FI-G-10S-W3	
10	800	7	32	49	17	19	22	4,23			
.39	11600	.28	1.26	1.93	.67	.75	.87	9.30		FI-G-12S-W3	
12	630	8	34	51	19	22	24	5,88			
.47	9135	.31	1.34	2.01	.75	.87	.94	12.94		FI-G-14S-W3	
14	630	10	38	57	22	24	27	7,52			
.55	9135	.39	1.50	2.24	.87	.94	1.06	16.54		FI-G-16S-W3	
16	630	12	38	57	21	27	30	9,20			
.63	9135	.47	1.50	2.24	.83	1.06	1.18	20.25	FI-G-20S-W3		
20	420	16	44	66	23	32	36	14,27			
.79	6091	.63	1.73	2.60	.91	1.26	1.42	31.40	FI-G-25S-W3		
25	420	20	50	74	26	41	46	24,99			
.98	6091	.79	1.97	2.91	1.02	1.61	1.81	54.97	FI-G-30S-W3		
30	420	25	54	80	27	46	50	33,08			
1.18	6091	.98	2.13	3.15	1.06	1.81	1.97	72.77	FI-G-38S-W3		
38	420	32	61	90	29	55	60	53,80			
1.50	6091	1.26	2.40	3.54	1.14	2.17	2.36	118.36			

